

No. 34

MTN Head Quarters - Eva-tech wide decking boards

Fairlands, Johannesburg, 2025



Eva-tech

www.eva-last.com

EVA-LAST[®]
INSPIRED BY NATURE, DESIGNED FOR LIFE.

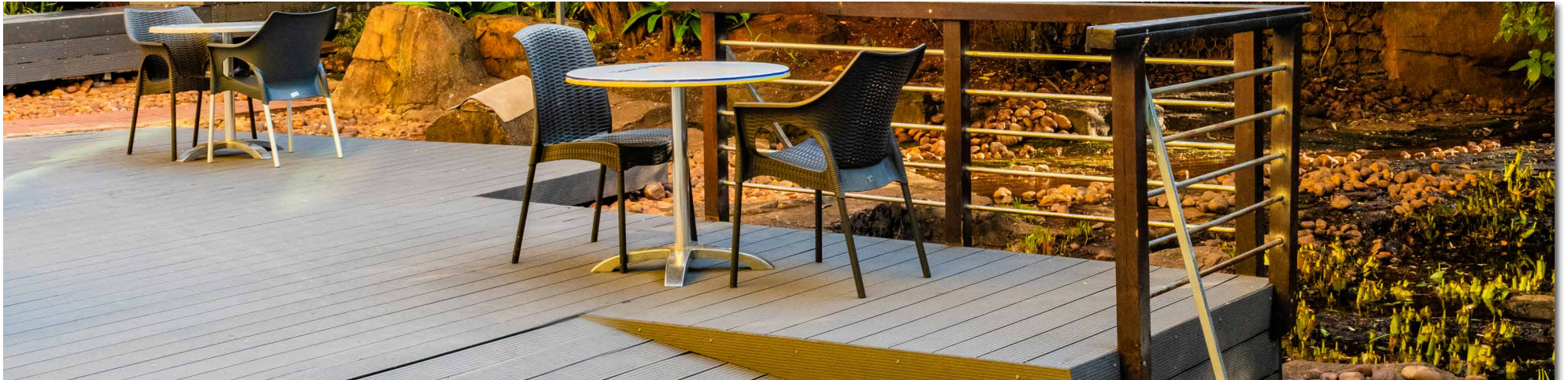

PROJECT DETAILS

Project Name

MTN Head Quarters

Project Type

Corporate

Description

Exterior

Date of Installation

April 2025

Main Contractor

Michael Mutrie, Gratification
Compatible Business

Main Developer

Johannes Setloboko,
MTN Facilities Specialist

Size

545m²

Project Location

Fairlands, Johannesburg

Product Used

Eva-tech wyde decking board in Xavia



MTN HEAD QUARTERS, FAIRLANDS, JOHANNESBURG, SOUTH AFRICA

Telecommunications giant, MTN is Africa's largest mobile network operator providing voice, data and sophisticated ICT solutions to over 300 million subscribers. Purposefully set up to offer a modern, connected life, the company's huge corporate infrastructure - from cellphone towers to fibre, data centres to cloud-based API offerings - is centrally controlled from their state-of-the-art campus in Fairlands, Johannesburg.

An extensive outdoor area features a wraparound deck with panoramic views of the city, servicing the staff canteen, service providers, and subscribers, with an attractive outdoor chill zone suitable for functions, meetings or simply a breath of fresh air. Originally built in 2010, this expansive L-shaped deck, as well as the elevated executive deck for top management, required replacement with a low-maintenance and durable alternative befitting the company and its legacy.

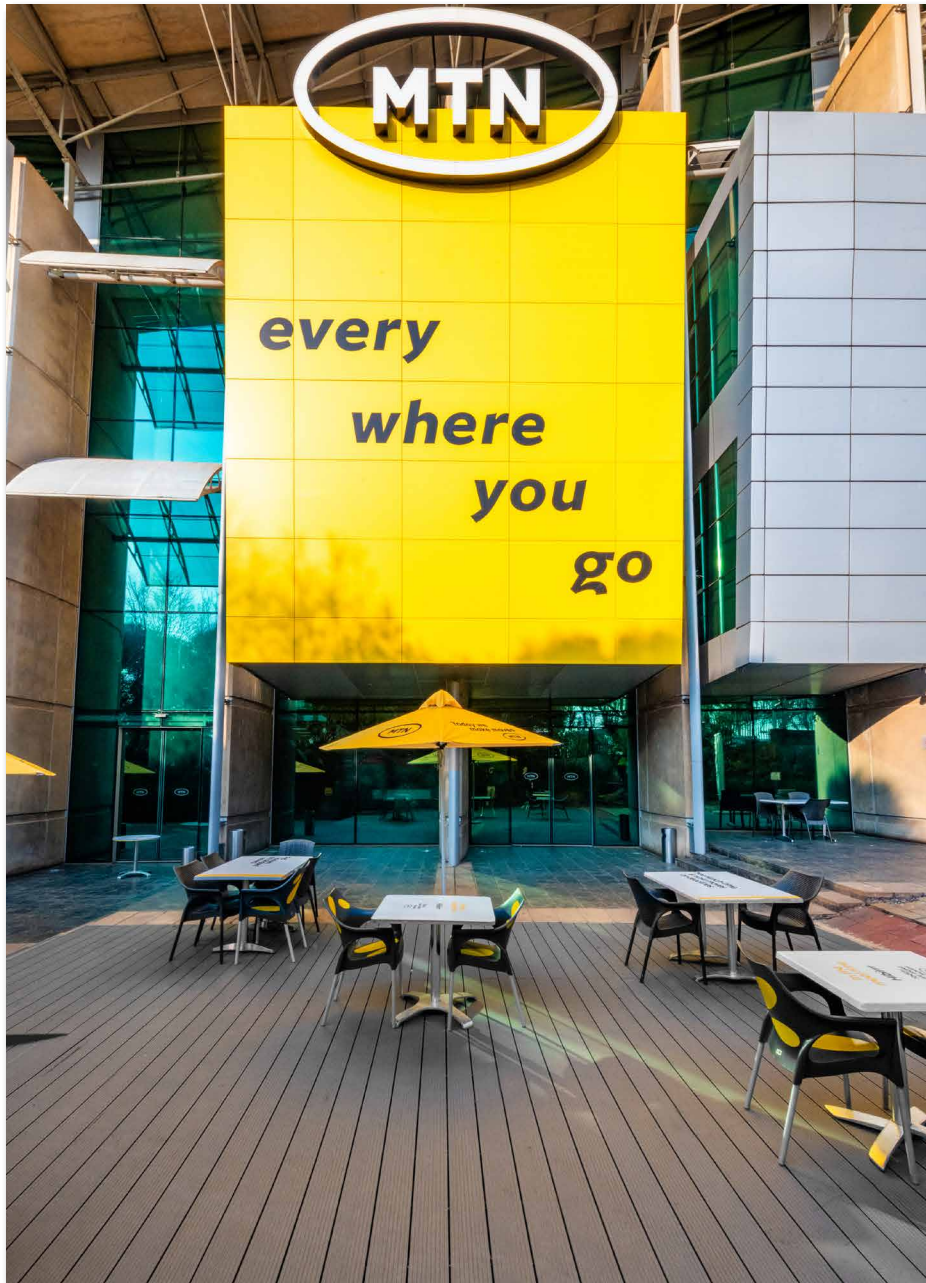

'Y'ELLO' LOW-MAINTENANCE STYLE AND SUSTAINABILITY

In line with the company's sustainability focus, MTN Facilities Specialist, Johannes Setloboko said "Y'ello" to low-maintenance style and sustainability by selecting Eva-Last's uncapped bamboo-PE composite decking, Eva-tech, in the Xavia colour.

With high visibility, and high-traffic zones subject to the harsh South African climate, both decks needed to enhance the natural surroundings, as well as tolerate typical temperature fluctuations ranging between zero to above 35 degrees Celsius in the summer.

The Eva-tech wyde pin-stripe design decking offered the perfect low-maintenance foundation to reflect the surrounding scenery.

Michael Mutrie from Gratification Compatible Business installed the stylish decking for Phase 1 outside the canteen with a steel-reinforced ramp providing wheelchair access alongside the small stairways of the terraced platform. Splashes of yellow on the ramp's edges and outdoor furniture echo MTN's corporate colours which are perfectly complemented by the matt grey tones of the Eva-tech composite deck.



A striking and precision-placed herringbone joint was created along the extended exterior perimeter decking of Phase 2. The Eva-tech boards were placed perpendicular to the abutting Phase 1's boards for a neat, decorative design.

Above, the elevated Eva-tech decking outside the executive suites replaced the worn wooden decking over the existing sub-structure. This ensured a safe, splinter-free surface that is moisture-resistant, won't warp or crack, and allows adequate draining while looking as good as the day it was installed.

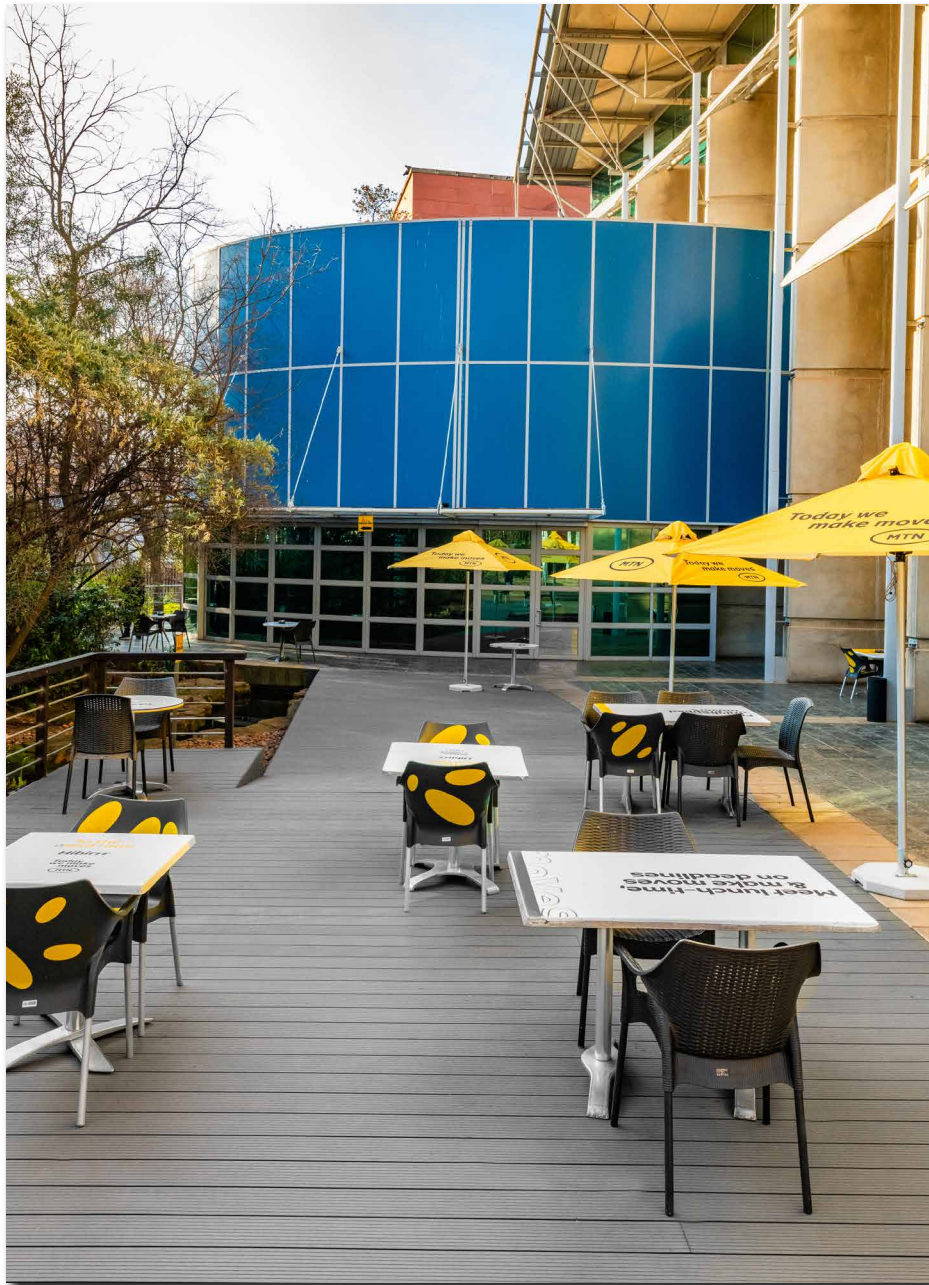

EVA-TECH FOR HI-TECH MTN

Eva-tech's eco-friendly bamboo-PE (polyethylene) composite decking is moulded from recycled plastic combined with bamboo fibers, giving it a texture that guarantees a grippy, non-slip, weatherproof and insect-resistant surface.

With a 10-year warranty, Eva-tech is engineered to perform, and guaranteed not to rot, mold, discolour or decay, ensuring a low-maintenance, easy-to-clean, and long-lasting deck that won't need constant maintenance and upgrades.

The patented I-Series grooved board profile was ideal for the area's extended span. The lightweight, cost effective profile still creates a strong and sturdy surface over an expansive area. Convenient starter boards, and trim fascia boards ensured a neat and tidy finish on the stairs and deck edges, while the colour-matched fasteners provide an invisible, but secure surface to complete the seamless look.

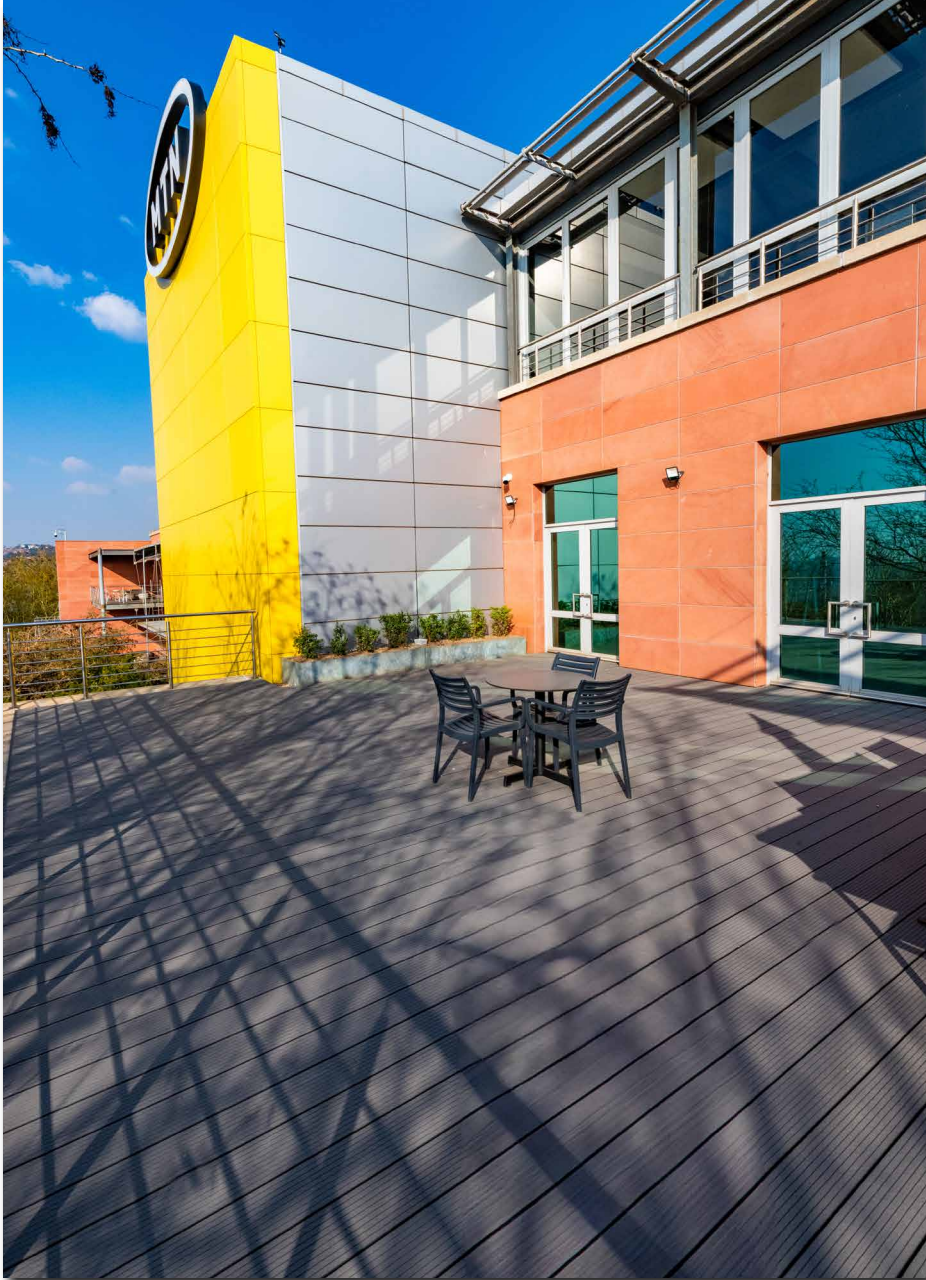

KEY INFLUENCER QUOTE

“The Eva-tech decking looks as good as the day it was installed and answered all our specifications in terms of sustainability and low-maintenance. Not only does it look the part, but it was quick to install with minimal disruption to our business,” says Johannes Setloboko, Facilities Specialist at MTN Head Office.



SUMMARY

When Africa's leading telecommunications giant MTN needed their extensive outdoor decking replaced, Eva-Last answered the call with a high-tech, low-maintenance, long-lasting and eco-friendly solution.

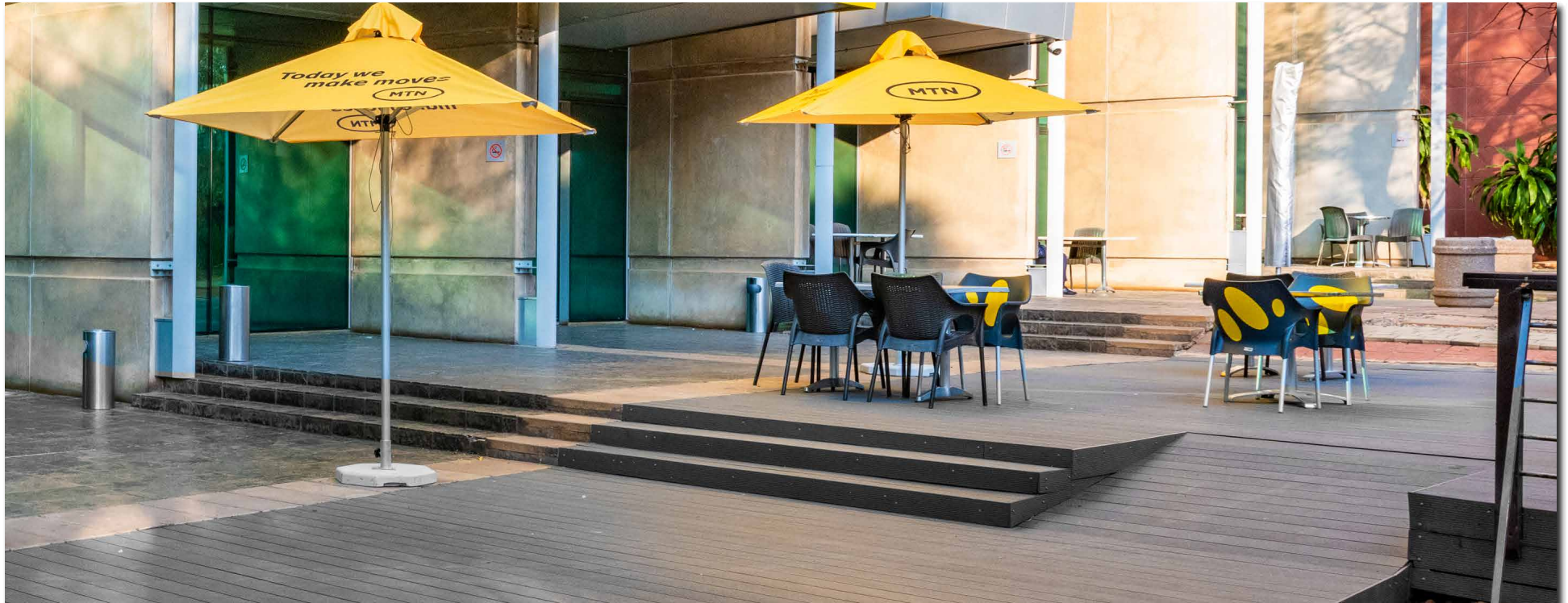

ABOUT US

Eva-Last is a globally reputable brand that utilises a solution driven business model to create innovative, sustainable building materials and systems that add value to customers' lives. At the heart of Eva-Last is a team of highly capable, creative specialists united by a passion to promote environmental consciousness through eco-friendly building products and operations. By embracing low environmental impact manufacturing and cutting-edge composite technology, Eva-Last is revolutionising how building can be done. We design and deliver beautiful, long-lasting green alternatives that make our customers' lives easier, healthier, and just plain better.





Eva-tech

www.eva-last.com

EVA-LAST[®]
INSPIRED BY NATURE, DESIGNED FOR LIFE.